



HIRSCHMANN

A **BELDEN** BRAND

Mounting Instruction

Directional diversity Antenna linear for 2.4 GHz BAT-ANT-N-MiMoDB-5N-IP65

■ **Safety instructions**



WARNING

ELECTRIC SHOCK OR FALLING

Avoid mounting the antenna near power lines.

When installing an antenna from a ladder or elevating equipment, take precautions to avoid falling and ensure the equipment is securely positioned on solid ground.

Failure to follow these instructions can result in death, serious injury, or equipment damage.

■ **General instructions**

- ▶ If exposed to extreme environmental conditions, especially icy conditions or a polluted atmosphere, the connectors should be covered with a self-vulcanizing tape or a cold shrink tube.
- ▶ If you mount the antenna on a false ceiling make sure that it is made from material with low electromagnetic loss, for example mineral fiber.
- ▶ Secure the antenna in a proper manner to ensure that the antenna stays in a stable position during its whole life cycle.

■ **Disclaimer**

All pertinent country, state, regional, and local safety regulations must be observed when installing and using this product. For reasons of safety and to help ensure compliance with documented system data, only the manufacturer should perform repairs to components. This equipment must only be installed and serviced by qualified personnel.

■ **Measuring units**

The dimensions are in mm.

The tightening torques are in lb in and Nm.

■ **Mounting on the ceiling without brackets**

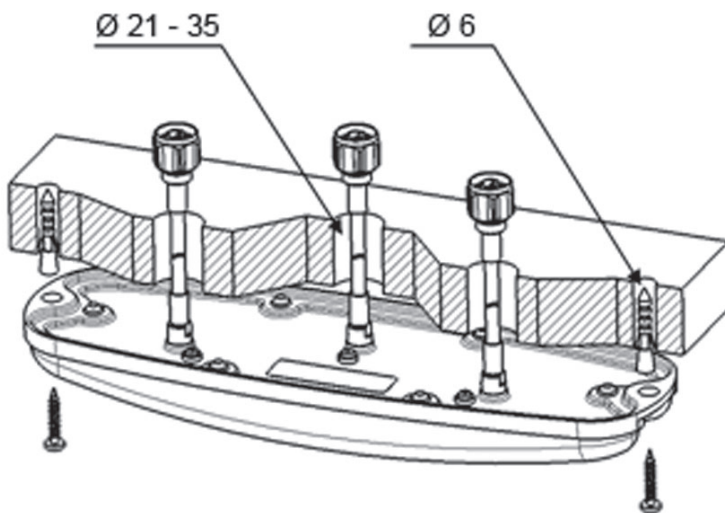

Figure 1: Mounting on the ceiling without using the mounting accessory

■ **Mounting on the ceiling using brackets**

- Mount the brackets on the ceiling.
- Mount the antenna on the brackets.

Note: Use a tightening torque of 106.2 lb in / 12 Nm.

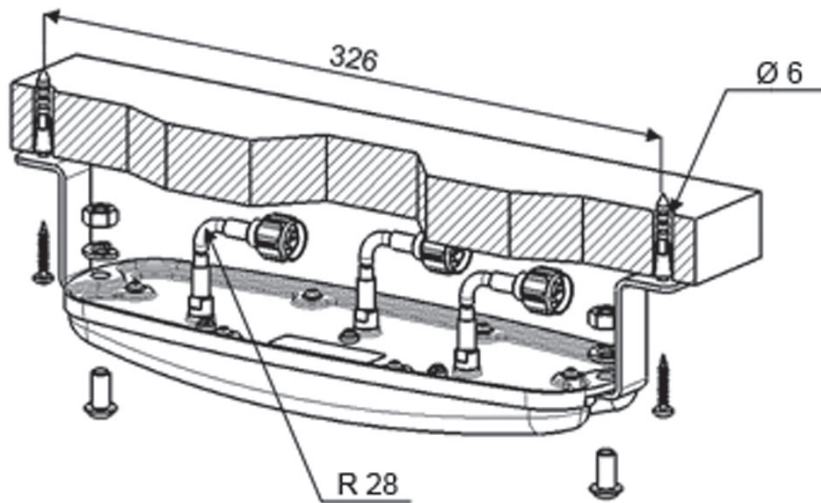

Figure 2: Mounting on the ceiling using the mounting accessory

■ **Reverse mounting on the ceiling using brackets**

- Mount the brackets on the ceiling.
- Mount the antenna on the brackets.

Note: Use a tightening torque of 106.2 lb in / 12 Nm.

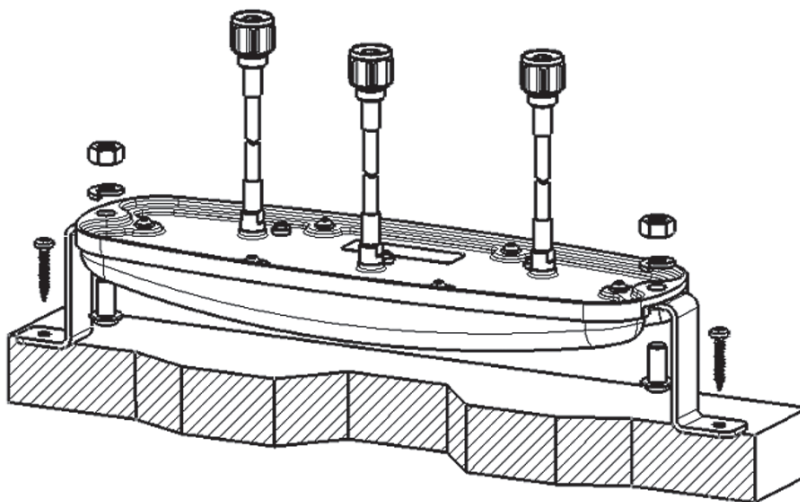

Figure 3: Reverse mounting on the ceiling using the mounting accessory

■ **Drilling template**

On the next page you find a drilling template on scale 1:1.

